

## Performance Core Pins®

Performance Core Pins offer a beryllium-free copper alloy alternative to steel core pins, delivering 6–10 times faster heat transfer than steel and double the rate of beryllium-copper alloys. Available in 61 sizes with diameters from 3/32" to 3/4" and lengths of 3", 6", 8", 14", and 20", these precision-made pins can be titanium nitride (TiN) coated or chrome plated for wear resistance with abrasive-filled resins. TiN coating is recommended for sleeve applications, though uncoated pins perform well due to the copper alloy's low friction with steel sleeves.

### Features

- Unit of measure: inch
- Beryllium Free
- Material: MoldStar® 150
- Hardness 95-98 Rockwell "B" (11-21 Rockwell "C")
- Higher tensile strength than P-20 tool steel
- Retains the inherent corrosion resistance of copper
- Reduces post-mold shrinkage issues
- Requires no additional heat treatment
- Six times better conductivity than steel
- Two times better conductivity than beryllium copper core pins

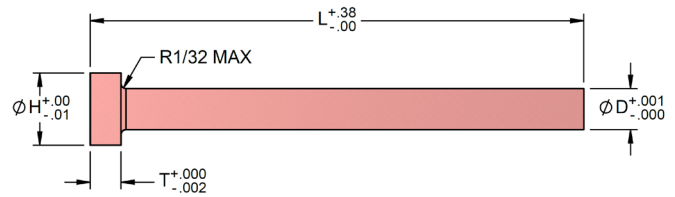

PCL

Nominal Diameter	D Actual Diameter	H Head Diameter	T Head Thickness	L Overall Length 3"	L Overall Length 6"	L Overall Length 8"	L Overall Length 14"	L Overall Length 20"
3/32"	0.0937	0.25	0.125	PCL0703	PCL0706		PCL0714	
1/8"	0.125	0.25	0.125	PCL0903	PCL0906	PCL0908	PCL0914	PCL0920
5/32"	0.1562	0.281	0.156	PCL1103	PCL1106	PCL1108	PCL1114	PCL1120
11/64"	0.1718	0.343	0.187	PCL1203	PCL1206		PCL1214	
3/16"	0.1875	0.375	0.187	PCL1303	PCL1306	PCL1308	PCL1314	PCL1320
13/64"	0.2031	0.375	0.187	PCL1403	PCL1406		PCL1414	
7/32"	0.2187	0.406	0.187	PCL1503	PCL1506	PCL1508	PCL1514	PCL1520
1/4"	0.25	0.437	0.187	PCL1703	PCL1706	PCL1708	PCL1714	PCL1720
9/32"	0.2812	0.437	0.25	PCL1903	PCL1906	PCL1908	PCL1914	
5/16"	0.3125	0.5	0.25	PCL2103	PCL2106	PCL2108	PCL2114	PCL2120
11/32"	0.3437	0.562	0.25	PCL2303	PCL2306		PCL2314	
3/8"	0.375	0.625	0.25	PCL2503	PCL2506	PCL2508	PCL2514	PCL2520
13/32"	0.4062	0.687	0.25	PCL2703	PCL2706		PCL2714	
7/16"	0.4375	0.687	0.25	PCL2903	PCL2906	PCL2908	PCL2914	
1/2"	0.5	0.75	0.25	PCL3303	PCL3306	PCL3308	PCL3314	
9/16"	0.5625	0.812	0.25	PCL3503	PCL3506	PCL3508	PCL3514	
5/8"	0.625	0.875	0.25	PCL3703	PCL3706	PCL3708	PCL3714	
3/4"	0.75	1	0.25	PCL4103	PCL4106	PCL4108	PCL4114	